



GALERIE I & II



Here you are welcomed by an elegant interior of precious wood, delicate white limestone, fine fabrics and carpets in colours of gold, blue and cream. Enjoy the splendid view onto Promenadeplatz. Galerie I has a connecting door to Galerie II. From Galerie II there is also direct access to the first gallery of the Festsaal (ballroom). The rooms are located at the mezzanine of the hotel and can be reached via the main stairs of the lobby.

Technical equipment: State-of-the-art audio-visual equipment on request.

Galerie I & II												
Room	L x W x H in m	Size in sqm	Size in sqft	Daylight	Boardroom	U-shape	Cabaret	Classroom style	Banquet	Theater style	Reception	
Galerie I	9.1 x 7.2 x 2.4	65.5	705.0	yes	16	16	24	24	40	40	60	
Galerie II	14.0 x 11.3 x 2.4	158.2	1,702.9	yes	30	36	100	80	130	180	180	

Mezzanine

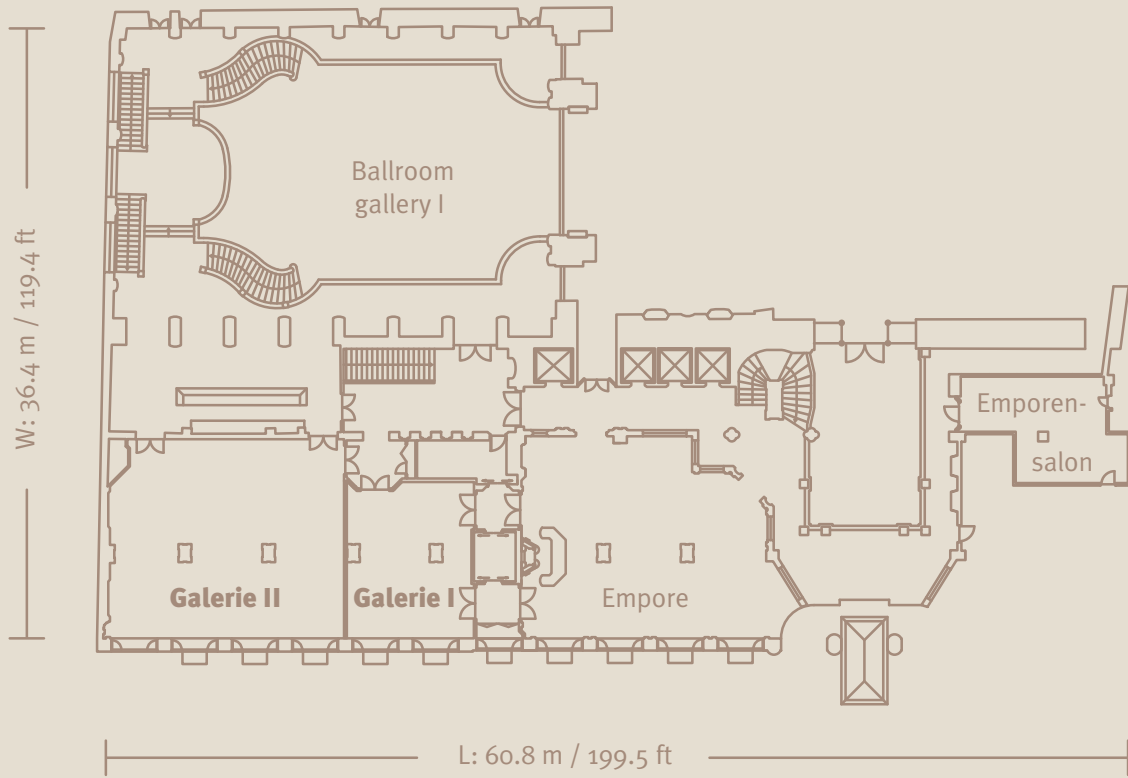

Galerie I+II: 185.8 sqm / 1,999.9 sqft, H: 2.4 m / 7.9 ft

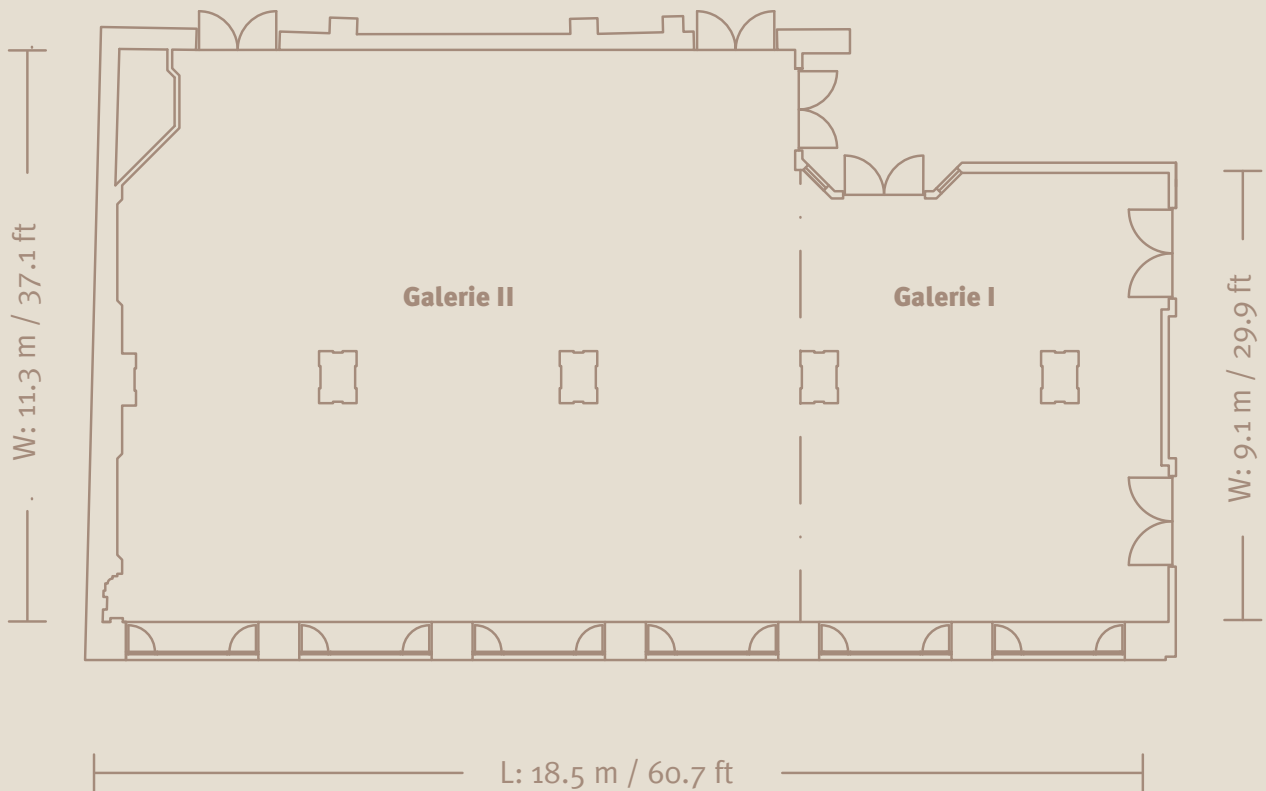

Hotel Bayerischer Hof

Promenadeplatz 2-6
80333 Munich, Germany

P.O.Box 100 253
80076 Munich, Germany

Phone +49 89.21 20 - 0
Fax +49 89.21 20 - 906

www.bayerischerhof.de
info@bayerischerhof.de

