



PALAIS KELLER



The Palais Keller and its rooms

In the Palais Keller, **Axel Vervoordt's** sensitivity for historical structures and his intuition for the shapes, colours and materials of the medieval vaults have imparted new energy and created new proportions. With a **total seating capacity for 196 people** over several areas and a total area of 682 square metres the space radiates peace and comfort and encourages guests to linger.

The Palais Keller and Palais Schwemme

The massive historical vaults were restored with their old masonry in its original condition, with doors and passageways in ideal proportions. An antique, 18th-century wooden ceiling from Italy was mounted in the entrance hall. The Palais Keller can seat 56 people in the main restaurant, and another 22 in the bar area and in the Palais Schwemme.

The Refektorium

In the Refektorium, the massive vaults and ancient masonry were also restored to their original conditions and now provide space for up to 44 people. The space features a long oak wooden table and a work of art by the Mexican artist Bosco Sodi, who is known for his richly-textured, large-format paintings.

The Tiroler Stube

The Tiroler Stube is an original inn parlour from the Paznaun Valley in Austria. It dates from 1823 and seats 18 people, providing a rustic, authentic, and warm ambience. The room remained untouched due to its uniqueness.

The Palaisstube

In the Palaisstube vestibule, antique wooden panels were mounted on the walls and ceiling. The finishing touch is a work of art by Tsuyoshi Maekawa. In the Palaisstube itself, the existing wood and ceiling panelling was restored and given a new coat of green paint, done in tempera. More wooden panelling and banquettes were added. To improve the parlour's proportions, it was reduced in size a little and now provides seating for up to 60 people within its fine carved walls and ceilings.

Palais Keller												
	Rooms	L x W x H in m	Surface in sqm	Surface in sqft	Daylight	Blocktable	U-shape	Cabaret	Parliamen-tary	Restaurant regular	Restaurant maximal	Reception
1	Refektorium	15,81 x 6,45 x 2,96	93,34	1004.70	no	28	–	–	–	28	44	60
2	Tiroler Stube	5,08 x 3,83 x 2,21	17,55	188.91	no	–	–	–	–	18	18	–
3	Palaisstube	13,45 x 5,91 x 2,78	79,73	858.21	no	26	–	–	–	48	60	80
4	Palais Keller & Palais Schwemme	23,57 x 9,33 x 2,96	169,50	1824.48	no	–	–	–	–	78	78	100

Palais Keller: 360,12 sqm / 3876,30 sqft

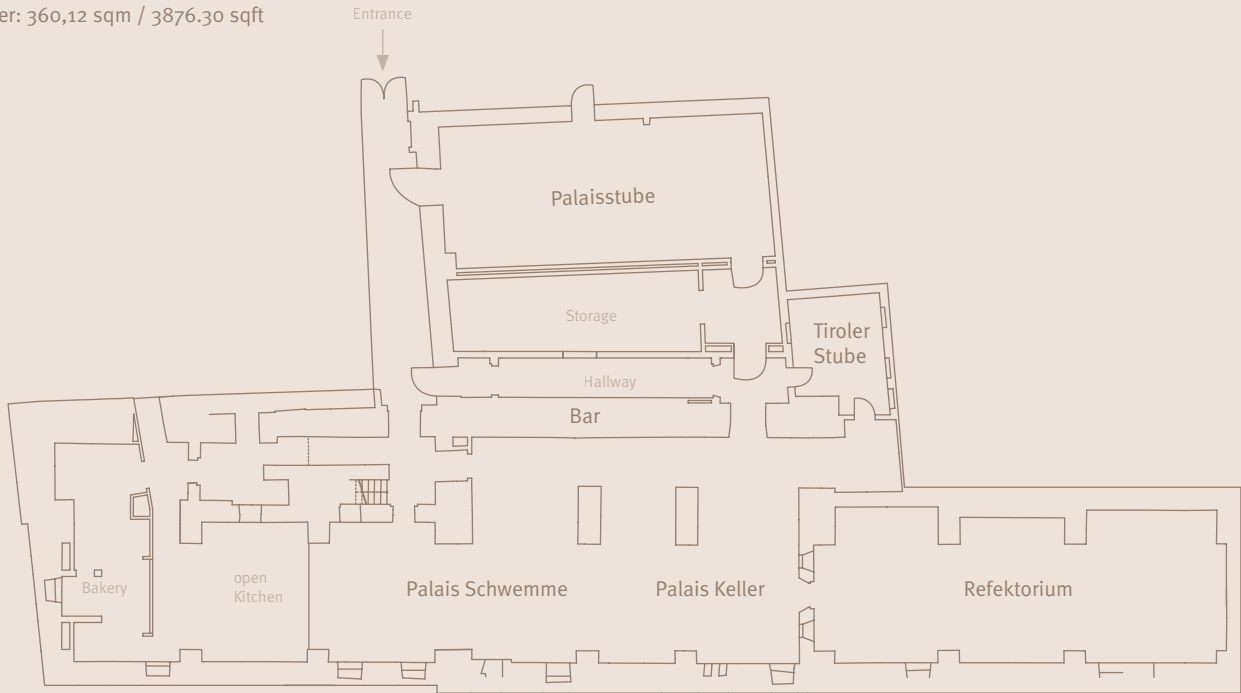

Palaisstube: 79,73 sqm / 858.21 sqft
H: 2,78 m / 9.12 ft

W: 5,91 m / 19.39 ft

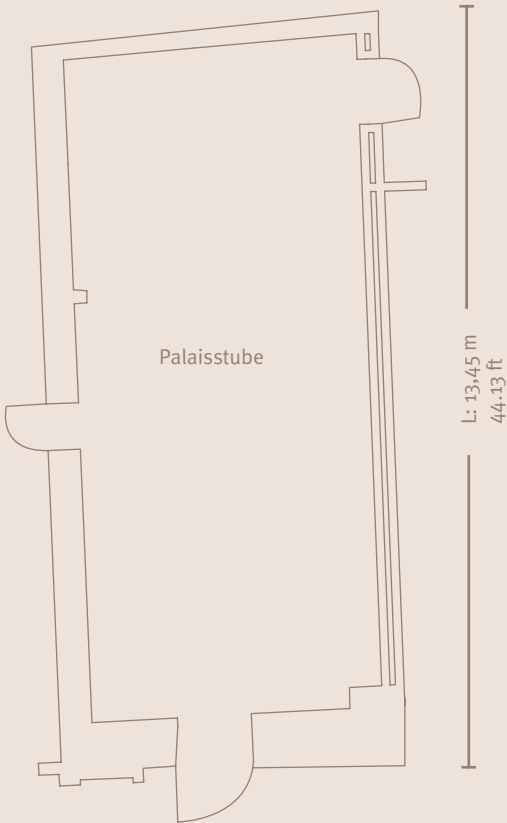

Refektorium: 93,34 sqm / 1004.70 sqft
H: 2,96 m / 9.71 ft

W: 6,45 m / 21.16 ft

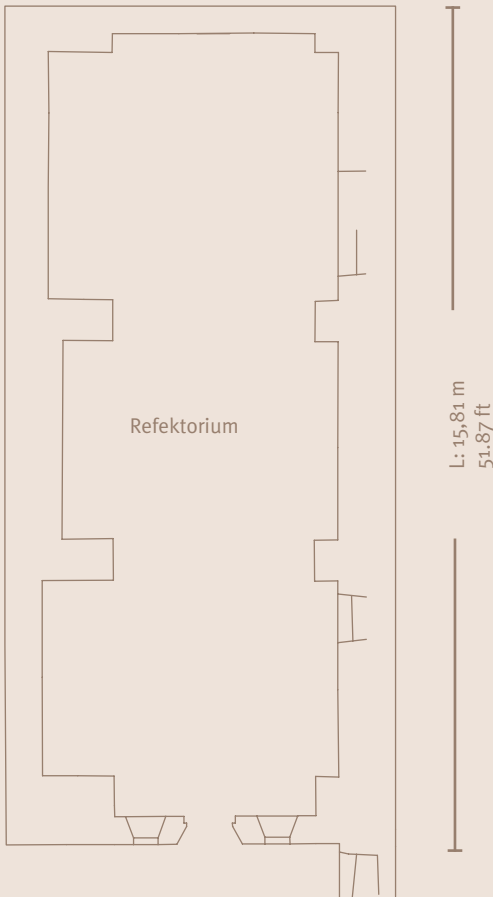

Hotel Bayerischer Hof

Promenadeplatz 2-6
D-80333 Munich, Germany

Phone +49 89.21 20 - 0
Fax +49 89.21 20 - 906

www.bayerischerhof.de
info@bayerischerhof.de

**LEADING
HOTELS®**

LEGEND
Preferred
HOTELS & RESORTS

